

KEEPING IT CLEAN
KEEPING IT CLEAN

PURASOLUTIONS™

SECTION TABLE OF CONTENTS

Which hand cloth is right for you?	102
Find a flat-mop system	103
Microfibre origami	104
Microfibre colour code system	105
Hand cloths	
Ultrafibre	106
Ultrasilver™	107
Microblade™	108
Floor care	
Biomop™	109
Kwik™ frames (Velcro®)	110
Kwik™ handles	111
Pre-soak method	112
AG Microfibre™ Velcro	114
AG Microsilver™ Velcro	116
Special tools	
Biostic™	118
Divided bucket (DB) system	120
Non-Velcro flat-mops (for DB)	121
Wall washing	122



ULTRAFIBRE

Which ultrafibre cloth is right for you?

With Atlas Graham you have choice. Choose AG Ultrafibre for everyday use or when the product will be laundered immediately after use. Choose Ultrasilver™ for the best in protection against cross-contamination by eliminating 99.9% of single-cell bacteria on the cloth.

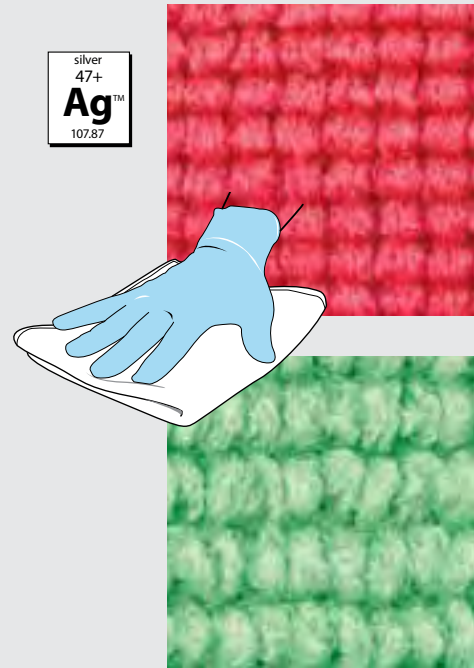

AG Silver Self-Sanitizing Technology

Atlas Graham's self-sanitizing Ultra Heavy Super Millentex® combines the cleaning power of ultrafibre with the antibacterial benefit of silver ion technology. The ultrafibre picks up dirt and bacteria from environmental surfaces and the silver ions bound to the fibre prevent the growth of micro-organisms within the cloth. This simple and safe solution adds one more layer of protection against the spread of infectious diseases in the workplace. This is our premium weight 430g/m² ultrafibre.

AG Ultrafibre

Ultrafibre Pola Millentex® cloths are still the benchmark of quality. The cloth is soft and durable with good consistency in the weave. This ultrafibre is a warp-knitted fabric that is very stable even after repeated washings. The weight of this fabric is 308g/m².

MICROFIBRE

Which microfibre flat-mop is right for you?

AG Microsilver™ is our premium, microfibre flat-mop with enhanced construction and silver self-sanitizing technology. The AG Microfibre is our standard flat-mop.

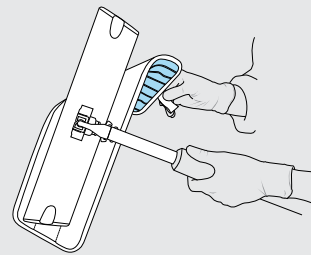

AG Microsilver™

AG Microfibre™

The decision is based on the flat-mop cleaning method and task.

The following page will help determine which microfibre flat-mop to choose. The AG Microsilver is offered in a Velcro®-backed flat-mop. Other factors include the type of floor (smooth or textured) or if you are applying disinfectants and finishes.

FIND A FLAT-MOP SYSTEM

Velcro® and non-Velcro options

1. KWIK, PRE-SOAK

The lightweight, adjustable Kwik™ System allows the user to save time and increase ergonomic comfort by pre-soaking the Z-velcro™-backed microfibre, flat-mops in a solution. Buckets come in 20L or 28L versions and are designed to fit the Kwik frame and microfibre flat-mops.

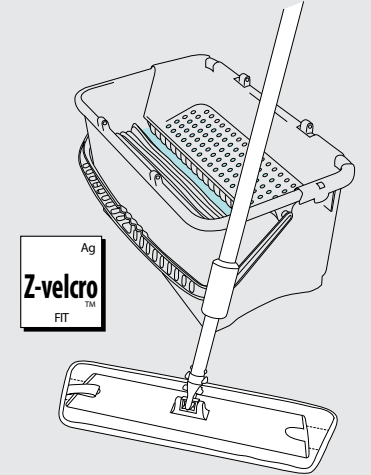

2. BIOSTIC™ ON-BOARD SOLUTION

This self-contained, bucketless, wringer-free tool is ready to go. The Biostic can also be deployed with a pre-soak system. The tool is also useful for cleaning stairs and for responding quickly to spills.

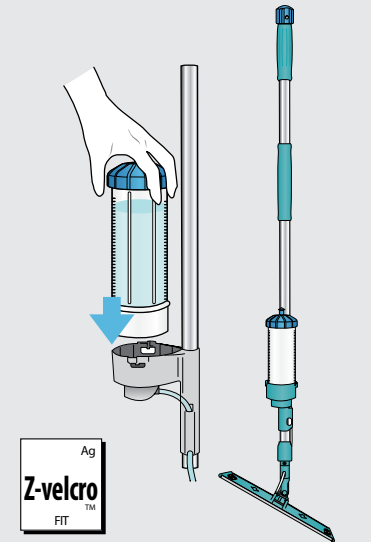

On-board cleaning solution can provide additional moisture to the pre-soaked pad when an area of stubborn dirt buildup is encountered. This method uses damp and wet microfibre flat-mops with a high-quality, Z-velcro™ back.

3. DIVIDED BUCKET

The collapsible, flat-mop frame and handle, used with the divided bucket, offer a bridge between the traditional wet mop procedure and the improved, ergonomic, flat-mopping microfibre system. The bucket is divided to separate dirty from clean water and features a drain for easy emptying. Use this method when dirt load is heavy. This method is a non-Velcro alternative.

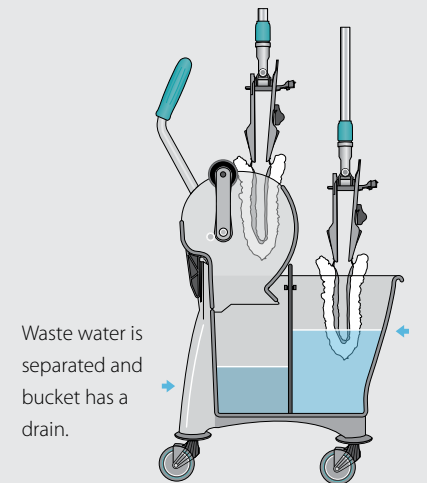

Waste water is separated and bucket has a drain.

MICROFIBRE ORIGAMI

Using hand cloths correctly

The history of origami dates back to old Japan, but did you know the ancient folding art can be used with microfibre hand cloths? Once the technique is mastered, a higher level of cleanliness and efficiency can be achieved. Now that's Kaizen.

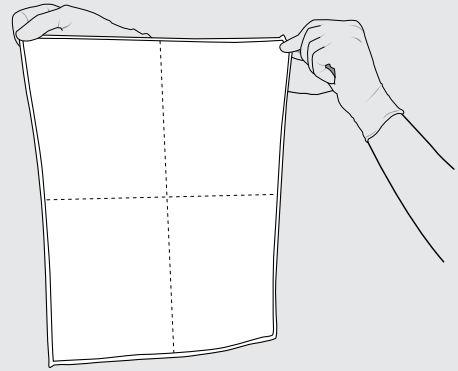

1. Every microfibre cloth has eight cleaning sides when properly halved and quartered. The secret to being efficient is to keep flipping the cloth over to reveal a new side.

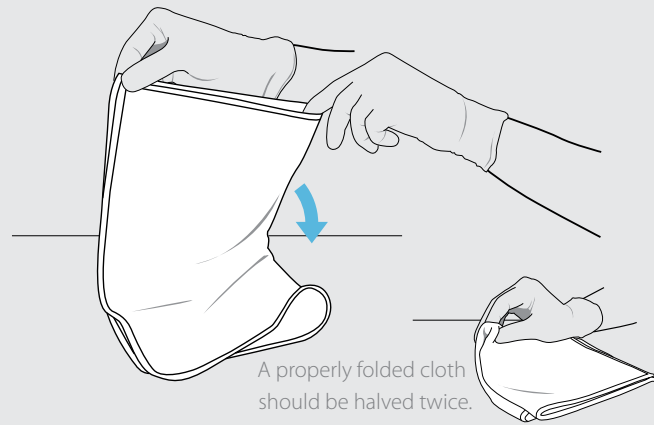

2. Start by folding the cloth in half. Then halve the cloth once more. The resulting shape should fit your hand.

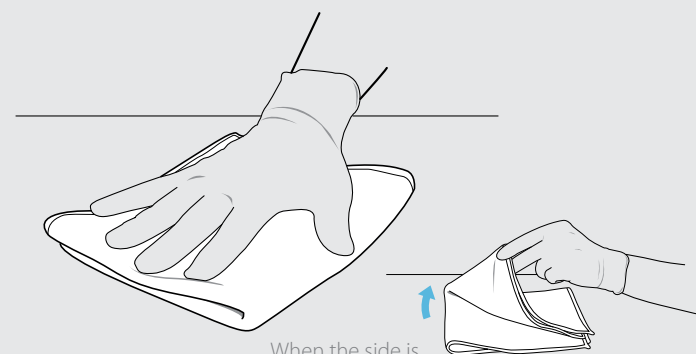

3. You are now ready to clean with style and ease. Just before the cloth becomes soiled, stop cleaning and flip the cloth over to reveal a new cleaning side.

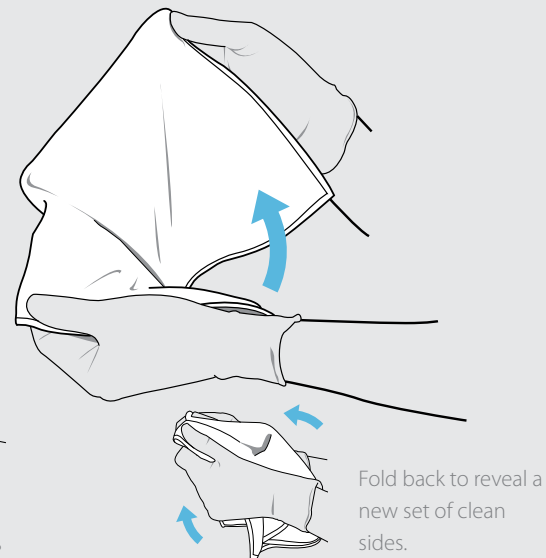

4. Once all the folds have been flipped for that side, unfold and start again using the other side of the cloth. A proper technique uses all eight sides.

MICROFIBRE COLOUR CODING

Clean by zones

Colour coding cleaning materials and tools ensures that these items are not used in multiple areas, therefore reducing the risk of cross-contamination. For this reason, microfibre hand cloths used on person contact points should be colour coded and changed often.



RED & PINK
Used in bathrooms, washrooms, showers, toilets and basins. Atlas Graham offers both red and pink cloths.



GREEN
Used in food preparation areas such as patient food service at ward level. Often used as a general purpose colour in North America.

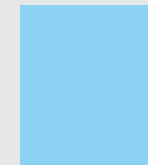

BLUE
Used in general areas including wards, departments, offices and basins in public areas. Atlas Graham also uses the colour blue for our glass cleaning cloth that has a silky texture for highly polished surfaces.



YELLOW
Used in highly critical isolation areas or where the risk of cross-contamination is greatest.

For the very best protection, we advocate employing a one-cloth-per-area cleaning strategy using AG Ultrasilver™ self-sanitizing microfibre.

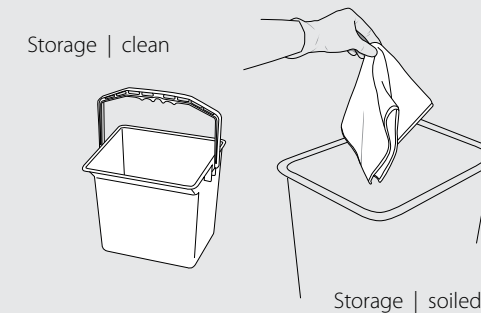

We recommend working with our implementation and training team to help develop a colour-coding scheme that works for you.

This colour scheme was adopted from The National Patient Safety Agency (NPSA) National Colour Coding Scheme for cleaning materials. There is currently no single colour-coding scheme in use across North America.

AG ULTRAFIBRE™

Standard ultrafibre

Pola Millentex® cloth is the standard to which all microfibre is compared. Use these cloths to clean person contact points.

LET THE FIBRE DO THE WORK

Ultrafibre is proven to pick up more dirt and bacteria than traditional wiping cloths. With ultrafibre, you let the microscopic qualities of the textile do most of the work, thereby reducing repetitive strain injuries.

colour	small	large	pack
green	603	643	5/bag, 5/case
pink	604	644	
grey	608	-	
yellow	80609	-	
blue†	605	645	

† Use blue for cleaning glass and other polished, smooth surfaces. Caution: Do not use on optical grade glass.



Colour coding reduces the risk of **cross-contamination**

AG ULTRASILVER™

Self-sanitizing ultrafibre

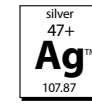

Silver has long been recognized as an effective and safe antibacterial agent. When the health and safety of employees and the public are at risk, choose Ultrasilver as your first line of defence.

AG SILVER SELF-SANITIZING TECHNOLOGY

Atlas Graham's self-sanitizing range of microfibre products combines the cleaning power of microfibre with the antibacterial benefit of silver ion technology. The microfibre picks up dirt and bacteria from environmental surfaces and the silver ions bound in the fibre prevent the growth of micro-organisms within the cloth or flat-mop. This simple and safe solution adds one more layer of protection against the spread of infectious diseases in the workplace.

HAND CLOTH

This microfibre is offered in one optimized size to fit the hand perfectly when folded and quartered. Each cloth when used correctly offers eight cleaning sides.

item	colour	size [cm]	pack
60372	green	30 x 38	5/bag, 5/case
60370	red		
60371	yellow		
60373	blue		
AG silver handyscrub: ultrafibre & polypropylene			
60360	blue	8 x 12	6



Handyscrub™



A safer workplace for everyone.

The potential for cross-contamination can happen during laundry collection. Ultrasilver renders any bacteria inert during the collection of soiled microfibre.



MICROBLADE™

High & low duster

Traps and holds dust for cleaning high or low surfaces. Slip-on ultrafibre sleeve can be used dry or damp for dust pickup.

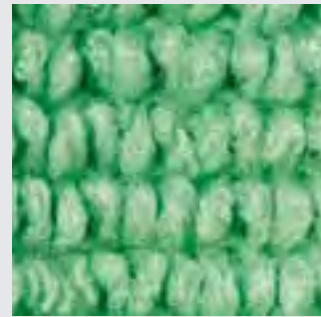

The slip-on sleeve is ultrafibre Pola Millentex™ for the very best in dust and grime pickup.

Quick connect handle is interchangeable with other Kwik™ System extension poles.



21801

36782

36781

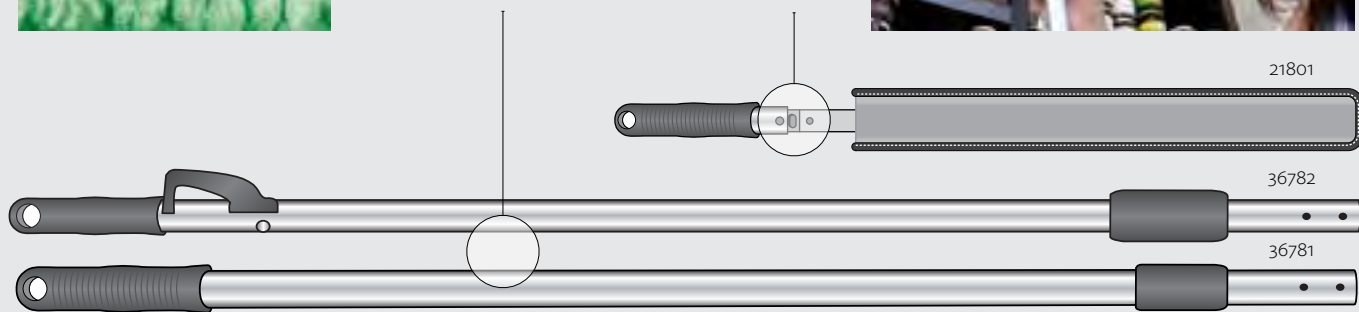

MICROBLADE™

The lightweight Microblade diminishes worker fatigue and the Kwik™ System handle options can be adjusted to reach high and low places with ease.

The Microblade bends to fit curved surfaces or can be used flat to increase coverage and cleaning efficiency.

Ultrafibre is 100-150 times smaller than a strand of human hair. The ends of the fibre are barb-like and work on a microscopic level to pick up germs.

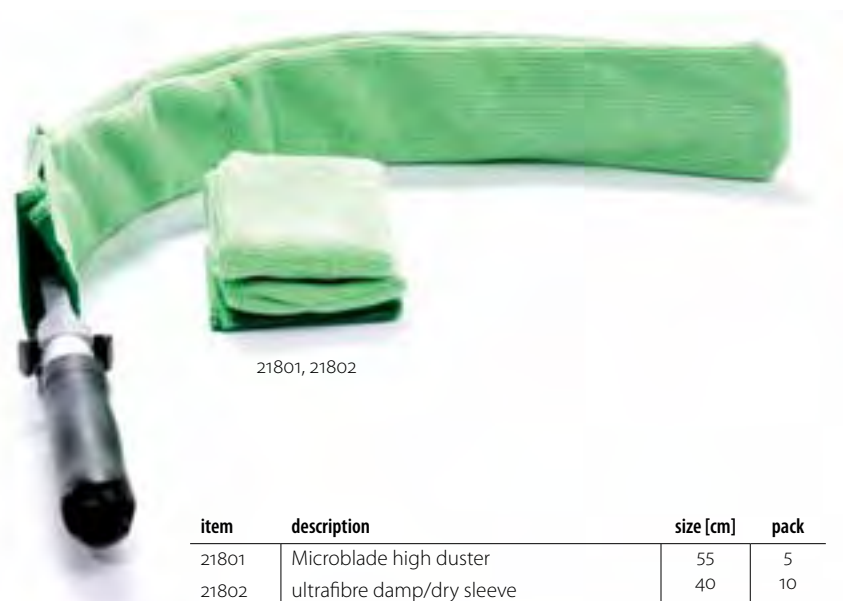

21801, 21802

item	description	size [cm]	pack
21801	Microblade high duster	55	5
21802	ultrafibre damp/dry sleeve	40	10
36781	aluminum Kwik adjustable handle	89-163	5
36782	telescopic Kwik-Lok™ handle	108-176	1

BIOMOP™ DRY MOPPING

Hygienic, disposable and biodegradable [flat dust-mop]

Traps and holds dust for the perfect green cleaning program.

The long, hair-like fibres pick up twice the amount of dust than the leading brand of sweeper.

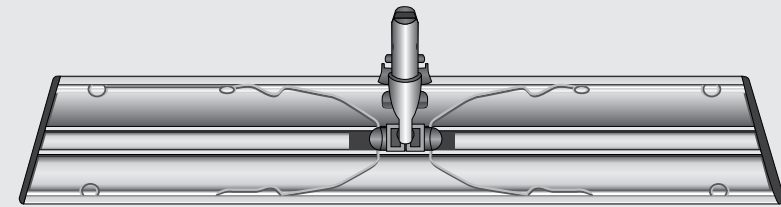

This product works both by creating a static charge and by mechanical entrapment.

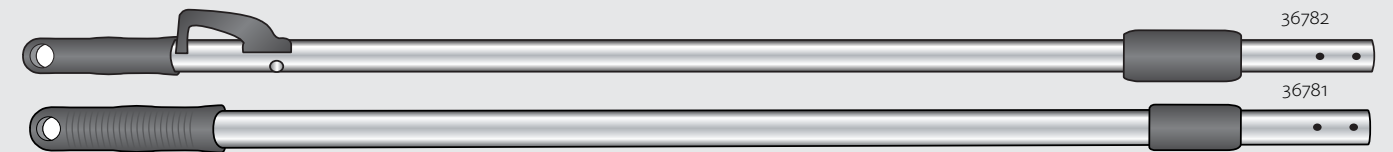

36782

36781

BIODEGRADABLE DUST MOP

The Biomop is an environmentally responsible, dry cleaning tool that fits within a green cleaning strategy. Biomop is both disposable and biodegradable, so it eliminates the need for costly laundering. What's more, it is effective at removing dust in a dry application, reducing the need for water and chemicals.

Its lightweight design diminishes worker fatigue and the Kwik™ System handle with spring-clip frame can be adjusted to accommodate any person's height.

The Biomop is available in commercial and retail sizes and can be used effectively in an ultra-hygienic environment.



77132



70143
21924

product	size [cm]	material	description	pack
70143	60.96	synthetic	200 Biomop sheets	1
21924	60.96	aluminum	Kiwk spring-clip frame and adjustable handle	1
146	60.96	aluminum	Kiwk spring-clip frame only	5
36781	89-163	aluminum	Kwik adjustable handle only	5
36782	108-176	aluminum	telescopic Kwik-Lok™ handle	1
21948	121.92	aluminum	extra wide Kwik clip frame	1
77132	30.48	synthetic	Biomop 16 sheets (retail)	12

KWIK™ FRAMES

Frames that use Velcro®

Are poor ergonomics weighing you down? If so, consider the Kwik System. It is the most advanced, flexible and ergonomic flat-mop system available.

The Kwik System frames are designed for professional use in a commercial environment. They are built with the highest grade extruded channel aluminum and composites available. The low-profile frame travels beneath door frames and the quick connector makes changing frames a snap. The vulcanized Velcro® hooks are perfectly matched to the mop's Z-velcro™. Frames are chemical resistant and autoclavable. Velcro can be removed without tools for cleaning or replacement.

Here's the spring-loaded quick connect feature.

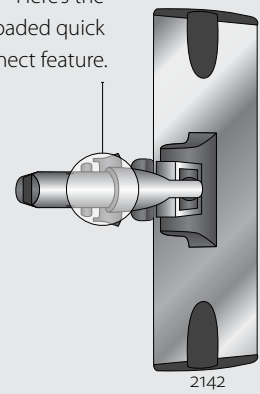

2142

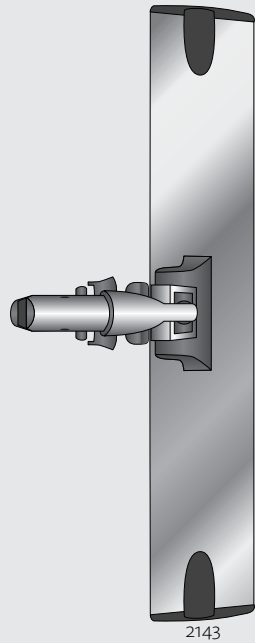

2143

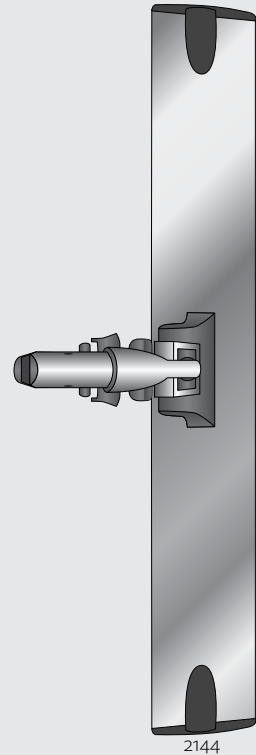

2144

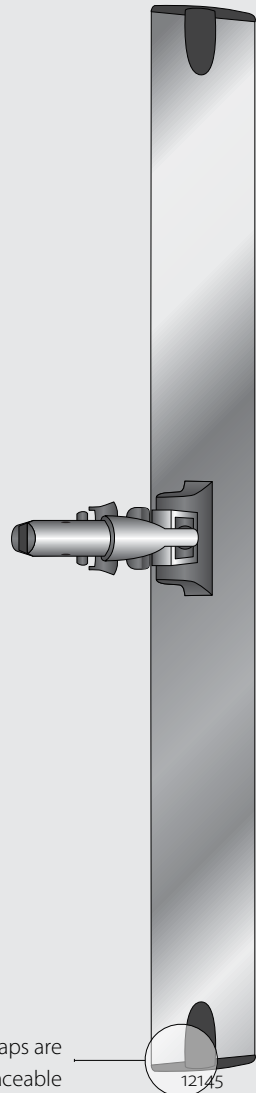

12145

End caps are replaceable without tools.

Kwik System uses interchangeable parts. The 60892 frame is a non-aluminum option.

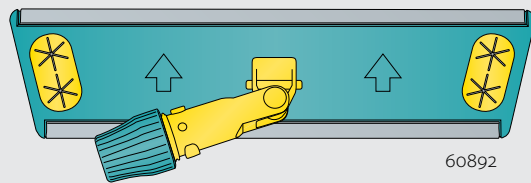

60892

Frame rotates 360° or locks down to clean vertical surfaces.

product	description	material	pack
2142	trapezoidal 23 cm	aluminum	5
2143	trapezoidal 40 cm	aluminum	5
2144	trapezoidal 55 cm	aluminum	5
12145	trapezoidal 90 cm	aluminum	5
12146	trapezoidal 120 cm (c/w handle & brace)	aluminum	1
60892	trapezoidal 40 cm (use with handle 61044)	polymer	5



KWIK™ HANDLES

Handles that fit Velcro®-based frames

This system sacrifices nothing when it comes to European fit, form and function. The system is lightweight and beautifully designed.

Handles

Handles are designed to click-and-lock. The aluminum handle is the highest quality available. High-impact polymer parts are able to withstand a commercial environment with repeated exposure to chemicals.

This equipment, including all the hardware such as Velcro, can be autoclaved should this be a requirement in a healthcare institution. Frames are constructed so that if a part wears out it can be easily replaced without tools.

product	description	size [cm]	pack
61044	telescopic handle (use with 60892)	100-185	10
36780	fixed handle	150	10
36781	telescopic handle	89-163	5
36782	telescopic Kwik-Lok™ handle	108-176	1

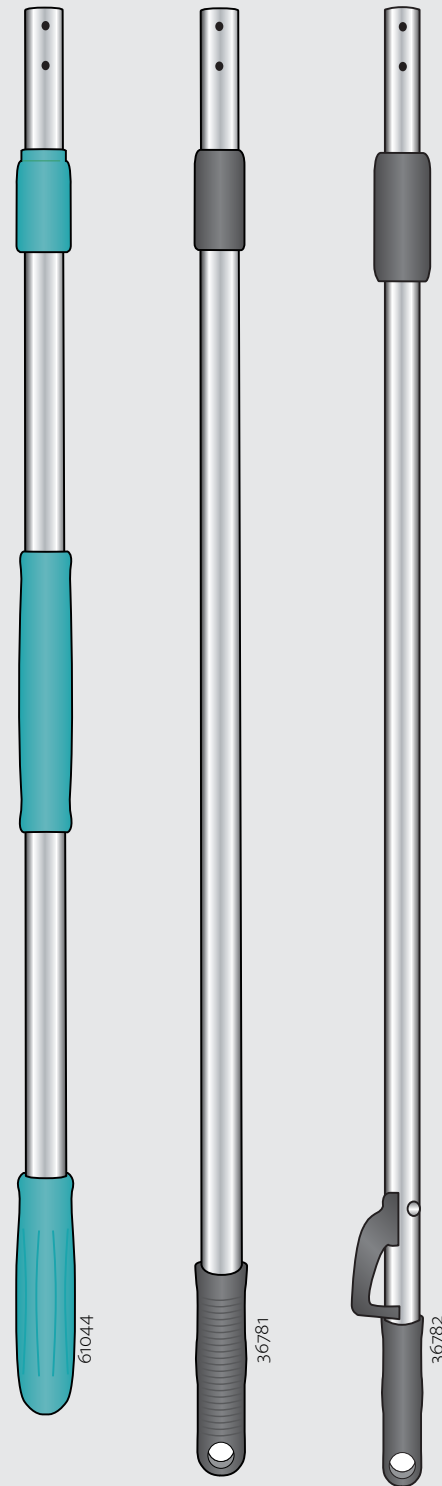

This system uses microfibre Velcro® flat-mops and the pre-soak system.

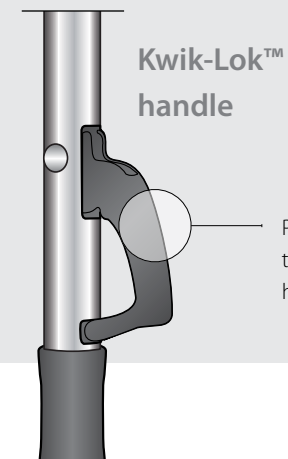

Kwik-Lok™ handle

Press down on lever to adjust the telescoping handle to the user's height or to get under furniture.

PRE-SOAK METHOD

Using Velcro® microfibre flat-mops

Rectangular buckets can be used to store pre-moistened, microfibre flat-mops. The bucket walls have a graduated scale for accurate measurement of water and solution from a dispensing unit.

Pre-soak, open bucket & sieve

AG has different pre-soak methods depending on whether the pre-soak method with an open bucket and sieve is used or the smaller, hermetically sealed bucket is utilized.

For specific instructions based on your requirements, please contact one of our professional microfibre training specialists.

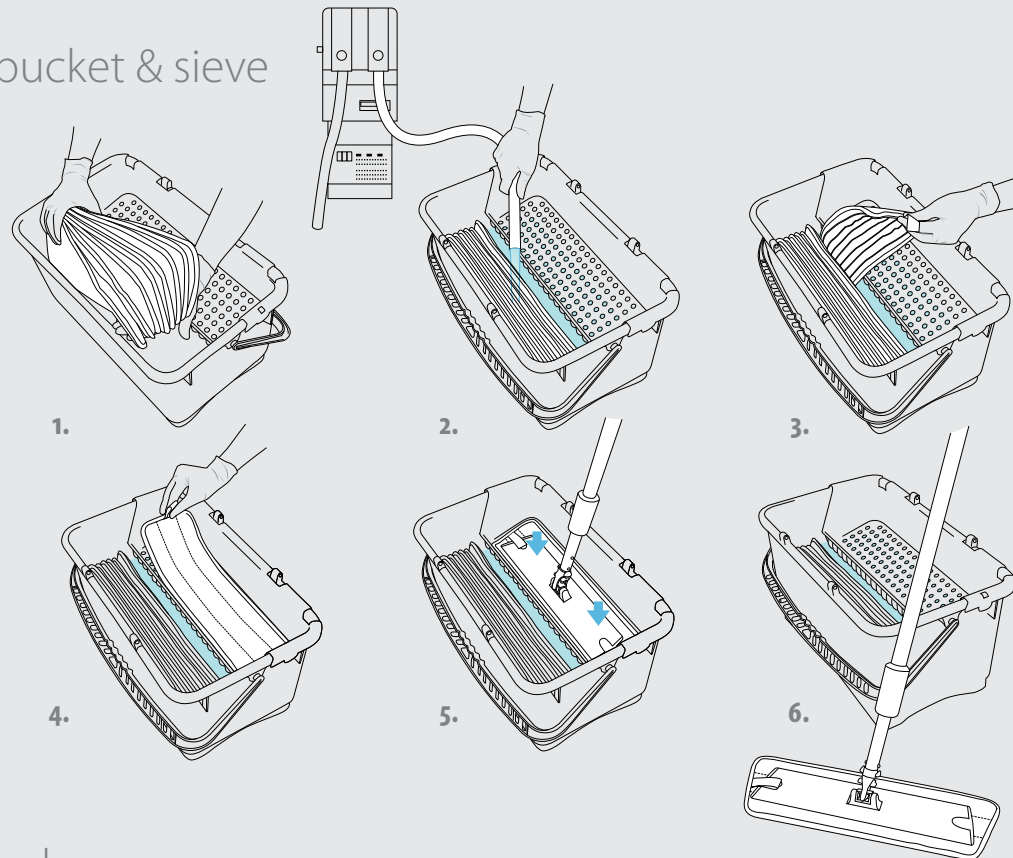

Remove and launder

Use your feet to avoid excessive handling of the soiled flat-mop. There are also end tabs on the flat-mop for handling the mop without touching soiled areas.

Ask one of our professional AG microfibre training specialists for laundering instructions that will help protect your investment.

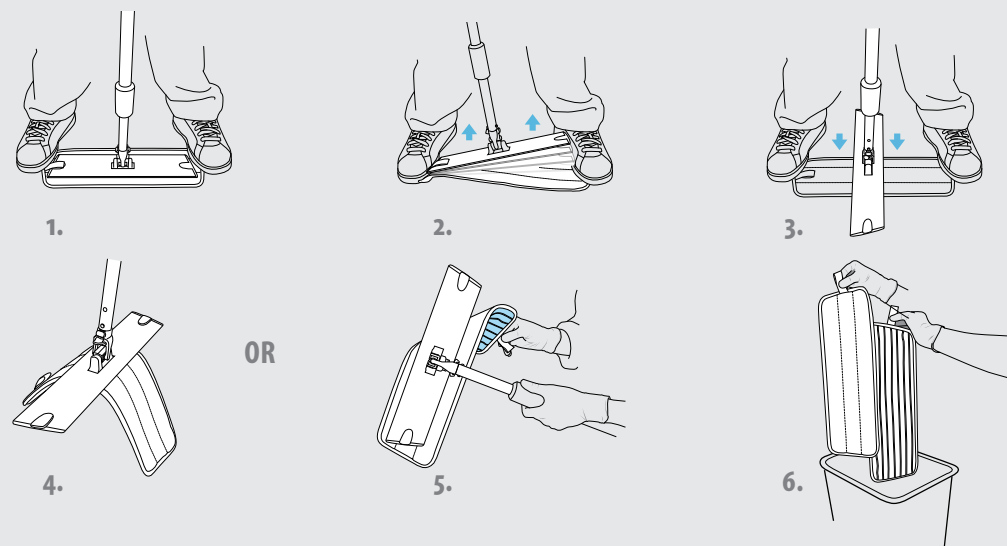

PRE-SOAK BUCKETS

For hand cloths and Velcro® flat-mops

One, pre-soaked flat-mop will effectively clean approximately 300 ft², about the size of an average room.



63210 & 63154



63361



63503

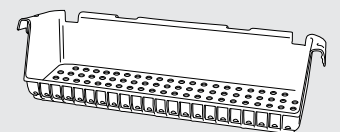

63154: Use the sieve on the 28L bucket.

Buckets and accessories

High-quality plastic 20L bucket used with a lid that has a gasket, achieves a leak-proof, hermetically sealed container. The larger 28L bucket uses a sieve.

Yellow pails fit the upper bin of any cart and can be used to store colour-coded hand cloths or to mix a solution for the pre-soak method.

product	description	colour	pack
63211	20L bucket	blue	
63212	20L bucket	red	4
63214	lid for 20L bucket	grey	
63210	28L bucket	blue	4
63154	sieve for 28L bucket	yellow	5

4L - pail	6L - pail	colour	pack
63360	63506	yellow	
63361	63505	red	
63362	63503	blue	4
63363	63508	green	

AG MICROFIBRE™ FLAT-MOPS

Z-velcro™ construction

Not all microfibre flat-mops are created equal. Subtle differences have a great impact on how the flat-mop performs and also on the durability of the mop during laundering.



AG MICROFIBRE™ FLAT-MOPS

Z-velcro™ construction

These damp flat-mops were introduced 10 years ago into some of Canada's most prestigious healthcare facilities. Today, they have proliferated into every sector. One thing remains constant: quality. Use these trapezoidal flat-mops with the Kwik™ or Biostic™ Systems.

MICROBLUE™

Use on smooth floors for damp or dry flat-mopping. This is a good, general purpose, microfibre pad. Polyester/polyamide microfibre reduces drag on the floor. Shape is trapezoidal to get into corners.

item	size [cm]	pack
60729	26/30	
60727	42/46	10
60728	56/60	



Use damp | smooth surfaces



MICROSCRUB™

Microfibre and polypropylene fibre has even less surface drag and is designed to provide more scrubbing action for tile, grout and stubborn deposits. Can be used to clean walls.

item	size [cm]	pack
60926	26/30	
60927	42/46	10
14504†	22	



† use with the 14505 wall-washing tool



Use damp | textured surfaces



ASTROLENE MF™

Use this product as a dry (dusting) floor pad only. Astrolene MF is constructed of 100% polyester microfibre for maximum dust pickup and minimum surface drag across a dry, high-gloss floor. Shape is trapezoidal to get into corners.

item	size [cm]	pack
60798	42/46	
60799	56/60	10
60790	94/98	
60791	126/130	



Use dry | smooth surfaces

Kwik™ frame

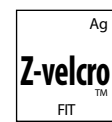

Z-velcro™ is perfectly matched to Atlas Graham's Kwik system™ and other competitor frames.

Pull tabs can be used to hang dry flat-mop when not in use.

AG MICROSILVER™ FLAT-MOPS

Self-sanitizing silver, Z-velcro™ construction

This self-sanitizing range of microfibre flat-mops combines the cleaning power of microfibre with the antibacterial benefit of silver. The microfibre picks up dirt and bacteria from surfaces and the silver ions bound in the fibre prevent the growth of micro-organisms within the flat-mop.

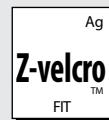
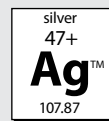

Superior materials ensure quality and durability.



1. Millentex® layer
Polyester microfibre
 Twisted loops provide increased laundry performance and durability while preventing lint-off. The polyester microfibre blend wears well and can be laundered with bleach at less than 10.7 pH.

2. Millentex® layer microfibre cloth
 One of the main benefits of Millentex is that it absorbs large amounts of water and slowly discharges it. This means the user doesn't have to add water frequently to recharge the mop during usage.

3. PET layer
Polyester non-woven
 The PET non-woven layer acts just like the Millentex cloth. It holds water, acting like a "sub-water tank," releasing solution as required. This layer also acts like a cushion, helping the performance of the mop even when the surface is uneven.

4. PP layer
Polypropylene non-woven
 This waffle layer adds structural integrity to the mop. It also prevents the rounded corners from curling up when the mop is laundered and subjected to heat.

5. Z-velcro™
Polyester backing
 The Z-velcro is the backbone of the flat-mop and provides just the right amount of cling to the Kwik™ frame. The Velcro is designed to last the life of the flat-mop and is considered the highest grade on the market.

6. Piping, fit & finish
Polyester tape
 The finishing tape is used to lock all the layers together. Rounded corners keep the mop flat.

Silver is a safe solution and adds one more line of defence from the spread of infectious diseases in the workplace.

Prior to World War II, the most powerful antibiotic, antibacterial and anti-fungal substance was silver. This technology is EPA-registered for a broad range of uses including food, water contact and textiles. Silver ion technology lasts the life of the product.

AG MICROSILVER™ FLAT-MOPS

Self-sanitizing silver, Z-velcro™ construction

AG Microsilver™ flat-mops are available in dry, damp and wet versions. Dry is used for dust mopping, damp is used for cleaning smooth and textured floors, and wet is used for applying germicides or floor finishes.

Did you know that dust mopping a floor takes a third of the time as wet mopping? Frequent dust mopping saves time and effort. Always dust mop before wet mopping.



Use dry | smooth surfaces

item	size [cm]	pack
60330	46	6
60331	60	6



Use damp | smooth surfaces
 General Purpose



Use damp | textured surfaces
 Softscrub™



Use wet | applicator
 Microfinish™



item	size [cm]	trim	pack
60320	42/46	blue	6
60321		green	
60322		red	



item	size [cm]	colour	pack
60340	42/46	blue	6



item	size [cm]	colour	pack
60350	42/46	grey	6



Our general purpose flat-mop is colour coded for facilities that want to segregate cleaning zones by colour.

BIOSTIC™ MOPPING SYSTEM

Z-velcro™ microfibre damp flat-mopping

The ultimate on-board solution tool with a low centre of gravity. Use in any commercial environment where a quick mopping system needs to be deployed. Great for stairs, small offices, schools and healthcare institutions.

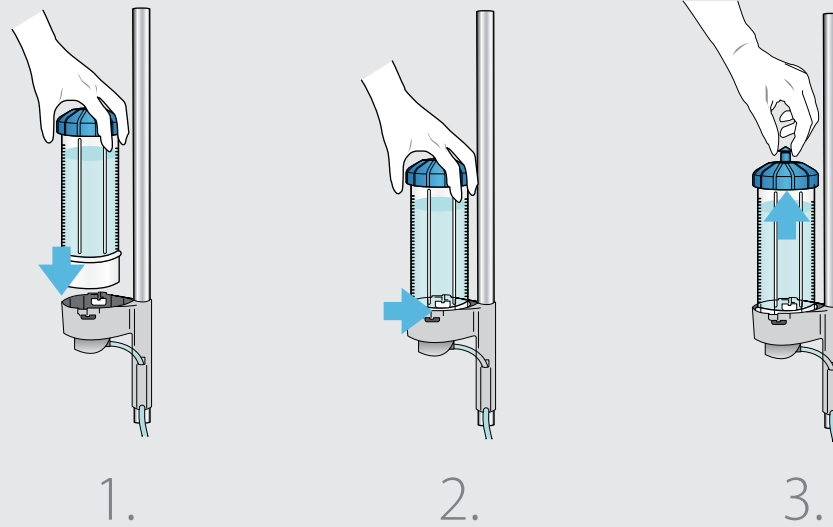

1. Insert chemical solution container into dispenser socket.

2. Turn container to lock into position.

3. Lift nipple on the lid of the container to release air and start the gravity flow.

Convenient push button distributes solution where and when you need it.

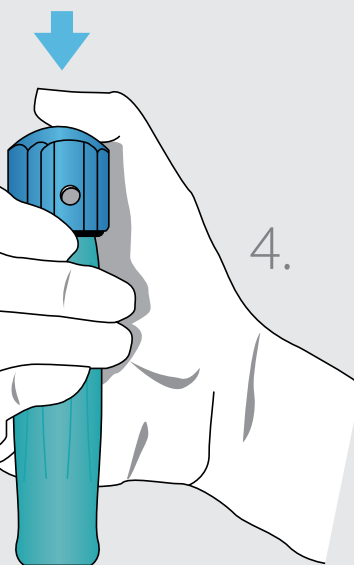

4. Press trigger on the handle end to release chemical solution as required or push and turn for continuous flow.

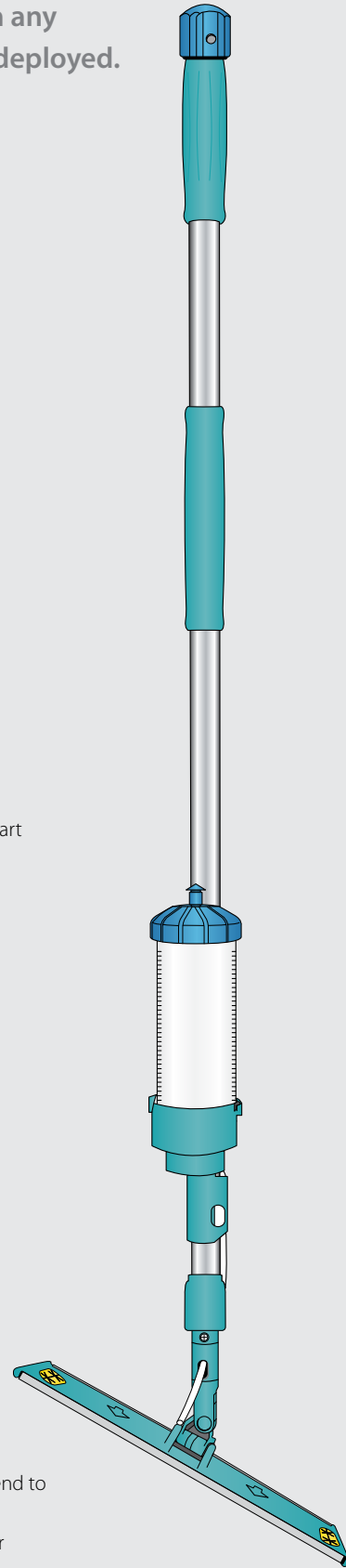

BIOSTIC™ MOPPING SYSTEM

Z-velcro™ microfibre damp flat-mopping

Whenever you need to dispense solution, just press a button on the handle. The Biostic uses Atlas Graham's Z-velcro™ technology with 42-46 cm trapezoidal microfibre damp flat-mops.



- Velcro® on the frame and our Z-velcro™ flat-mops are designed for a perfect match. The Velcro lasts the life of the tool when properly cared for.
- The System dispenses solution from the handle to the edge of the flat-mop.
- Mop buckets can be fertile breeding grounds for bacteria. Because no bucket is used, the Biostic is one of the safest choices for cleaning floors.
- Colour-coded solution containers allow you to designate different chemicals for different zones as needed.
- The flexibility of this modular approach allows you to clean a small or large area continuously.

item	description	pack
60970	Biostic 150 cm handle with 40 cm Velcro frame includes container	1
90971	replacement tygon tubing	



container	650 ml	pack
60461	red	5
60460	blue	
60463	green	
60462	yellow	
63518	tool caddy	4

The blue solution container comes standard on all Biostic models.



63518



DIVIDED BUCKET

A new twist on traditional wet mopping

This system saves time, effort and chemicals. A drain plug means you never have to lift the bucket in order to drain the contents. The bucket divider feature keeps the wash water fresher, longer. Use this system in dirty, high traffic areas or in long corridors.



The bottomless, roller wringer is designed to be used with the collapsible mop frame and handle. The sidepress can be used with (small size) traditional wet mops.



63403, sidepress

63410, roller wringer

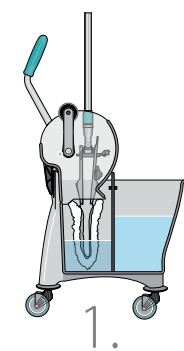

1. Rinse the soiled mop through the wringer.

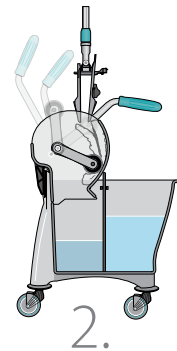

2. Wring the rinsed mop above waste water.

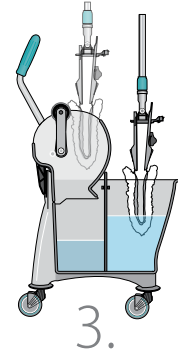

3. Re-charge mop in clean solution.

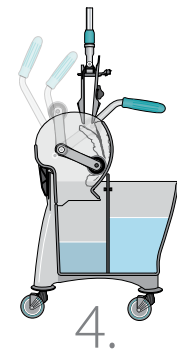

4. Wring excess solution and the mop is ready for use.

product	description	pack
66450	roller wringer & divided bucket	1
16450	divided bucket with drain	1
76450	sidepress wringer & divided bucket	1
63403	sidepress	1
63410	roller wringer	1
61044	telescopic flat-mop handle	10
60868	collapsible frame	5

Release the frame with the tap of a foot.



NON-VELCRO® FLAT-MOPS

Collapsible damp flat-mops with tabs

These mops are designed specifically for using the collapsible flat-mop frame and divided bucket with either a roller or sidepress wringer. Use these mops in dirty high traffic areas.

CUT-END FLAT-MOP

100% polyester with maximum dirt pickup on uneven floors and high-traffic areas. This damp flat-mop uses tabs with grommets to attach to the collapsible flat-mop frame.

This mop can be used dry for dust mopping.

item	size [cm]	pack
60547	45	10

LOOPED-END FLAT-MOP

Synthetic mop reduces drag on uneven floors and high-traffic areas. This damp flat-mop uses tabs with grommets to attach to the collapsible, flat-mop frame.

This mop can be used dry for dust mopping.

item	size [cm]	pack
60694	45	10

MICROBLUE FLAT-MOP

A good deep cleaning microfibre damp flat-mop for washing smooth floor surfaces. Uses tabs with grommets to fit the collapsible flat-mop frame and handle.

item	size [cm]	pack
60695	45	10



non-Velcro® (tab & grommet)



non-Velcro® (tab & grommet)



non-Velcro® (tab & grommet)

WALL WASHING

Cleaning vertical surfaces, two-bucket system

Cleaning walls or other vertical surfaces requires specialized tools in order to work efficiently. The tools featured on this page and the next work well together and form an integrated approach to wall washing.

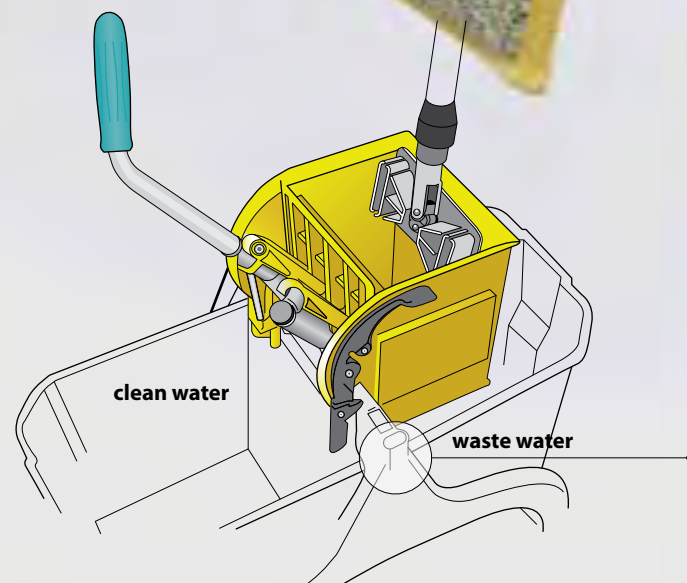

Shown with optional sidepress wringer.

The two buckets separate the clean water from the waste water.

WALL WASHING

Velcro®-based system

The dual 2-25L buckets with sidepress wringer, trolley and tool caddy are designed for washing vertical surfaces. Wash and rinse water are kept separate to reduce chemical use and back strain when emptying.



66188 | kit: dual bucket, downpress wringer, trolley, tool caddy.

description	item	pack
tool complete, w/cotton mop (14508)	14500	10
tool complete, w/Microscrub™ (14504)	14506	
Microscrub flat-mop refill	14504	10
cotton mop refill	14508	20
tie-on mop refill†	14509†	20
tool only	14505	10
dual bucket, wringer, tool caddy and trolley	66188	1
48-in. aluminum handle	1874	
54-in. aluminum handle	1880	10
58-in. aluminum handle	1858	

† Item 14509 is a tie-on style cotton mop that fits competitors' nine inch metal frames. We do not sell a frame for this mop.

WALL HUGGER WASH TOOL

The Wall Hugger is a task-specific mop frame for washing or dusting walls and ceilings. There are two types of mop head: a regular cotton, cut-end mop and a Microscrub microfibre flat-mop for a more aggressive scrubbing action. The sturdy frame can be used in all sidepress wringers and is the logical choice for wall washing. Available as a tool or as a kit with either type of mop.

ALUMINUM HANDLES

Telescopic high-grade aluminum handles with acme threads offer strength and safety. We recommend using extension poles instead of ladders to eliminate safety hazards.

item	max [ft.]	tip	material	pack
36708	8			
36712	12	acme	aluminum	6
36718	18			
36724	24			



14505 | Velcro®



14504



14508



14509† | tie-on